

4 'A'
1 : 50

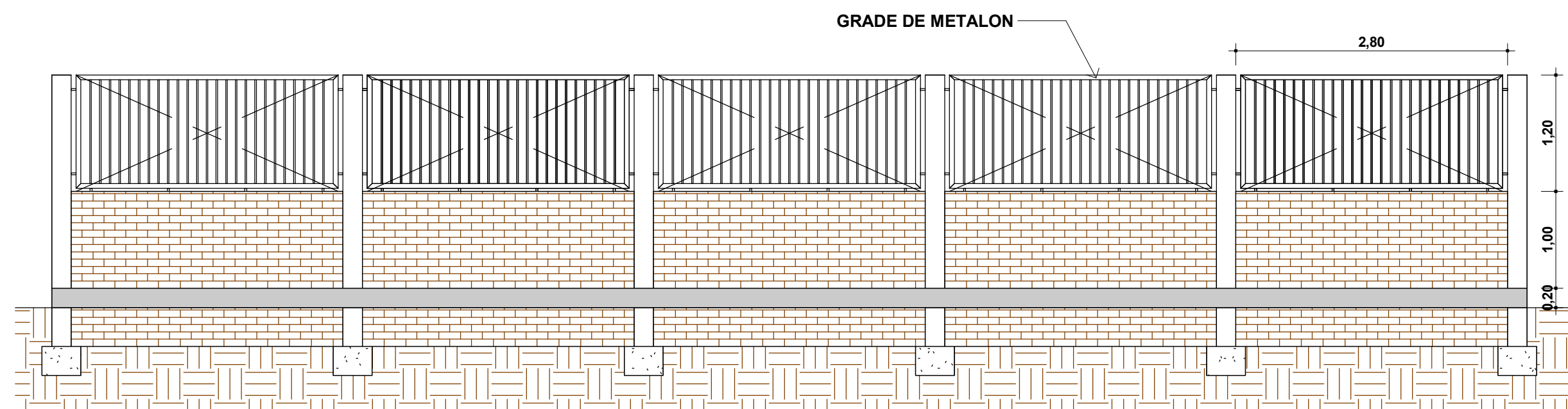

7
FRONTAL DO MURO
1 : 50

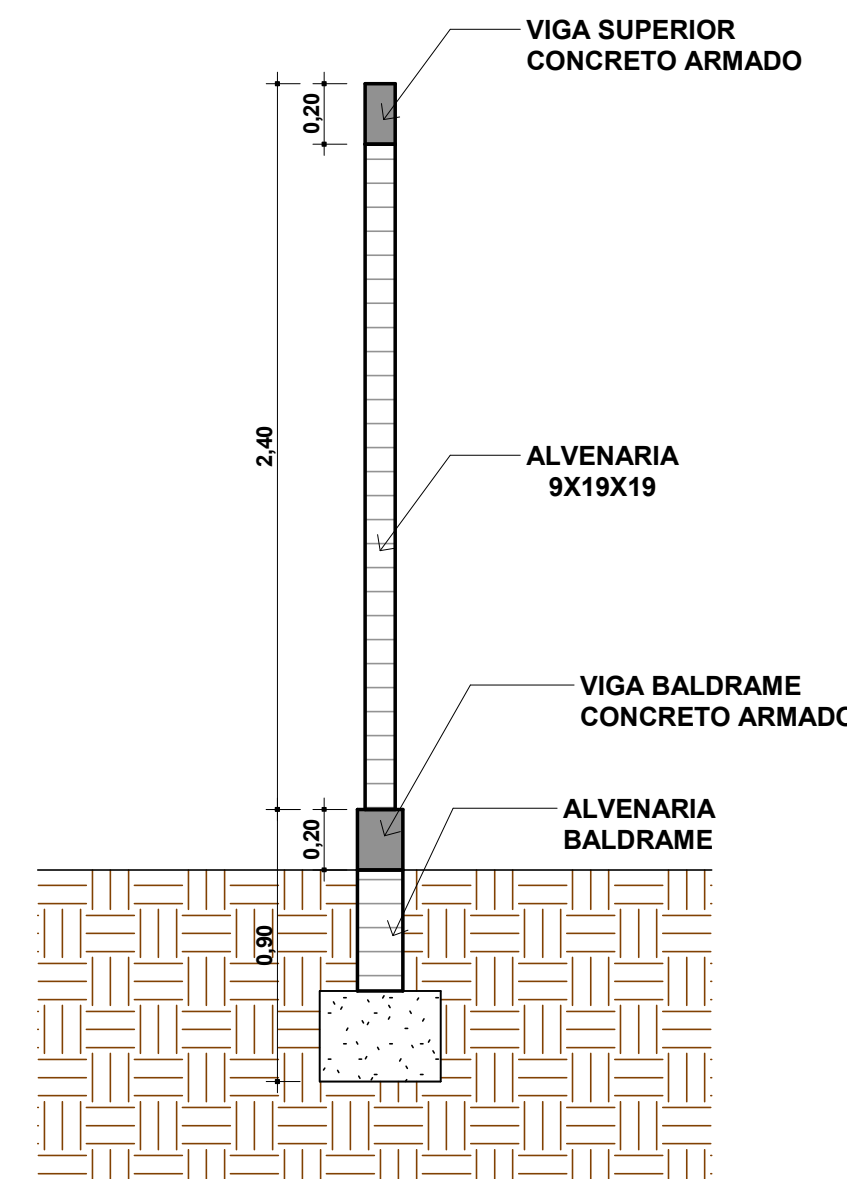

5 'B'
1 : 25

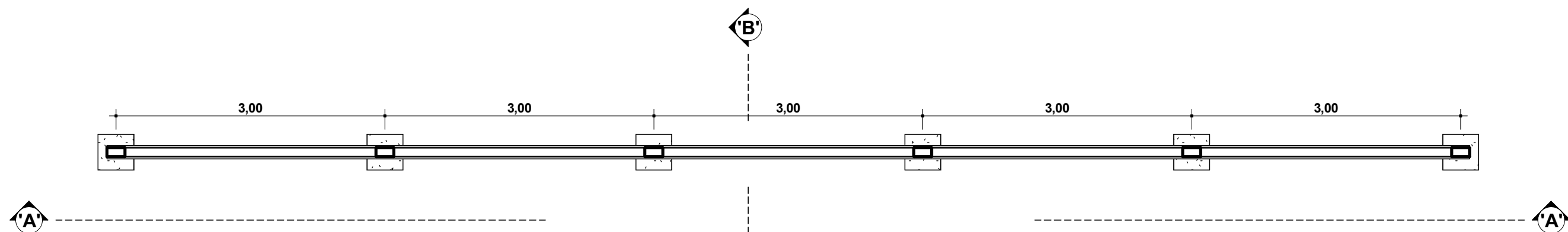

1 FUNDAÇÃO
1 : 50

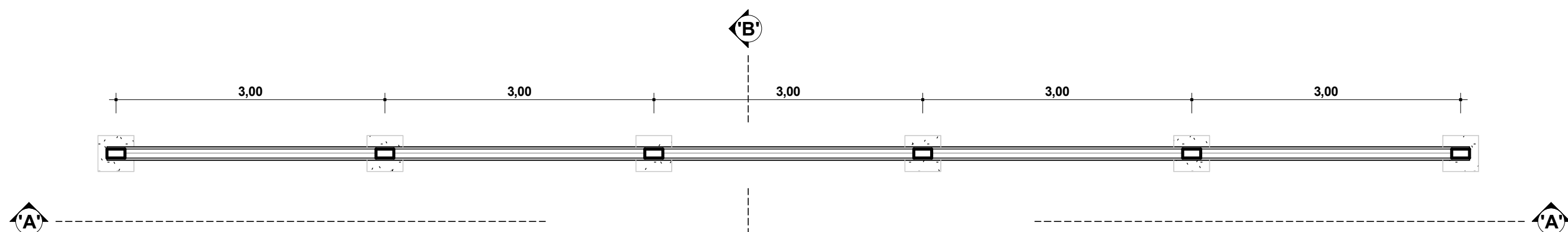

2 BALDRAME
1 : 50

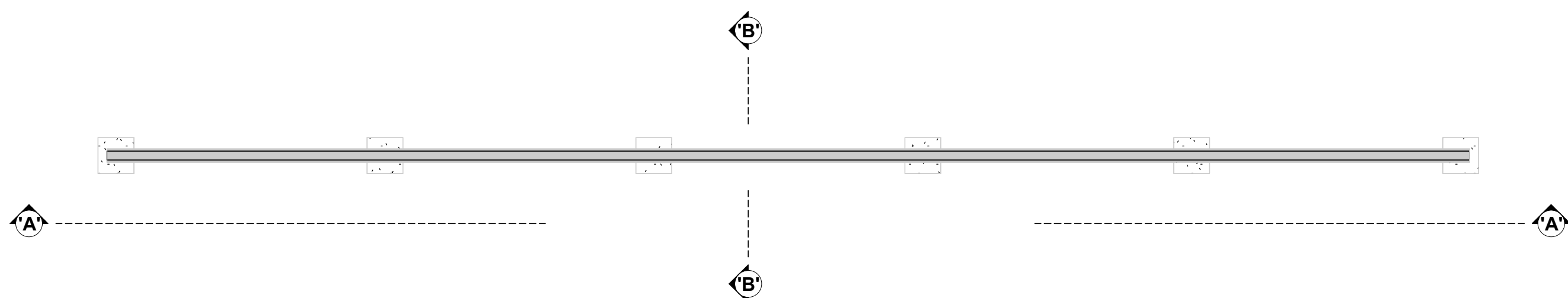

3 VIGA SUPERIOR
1 : 50

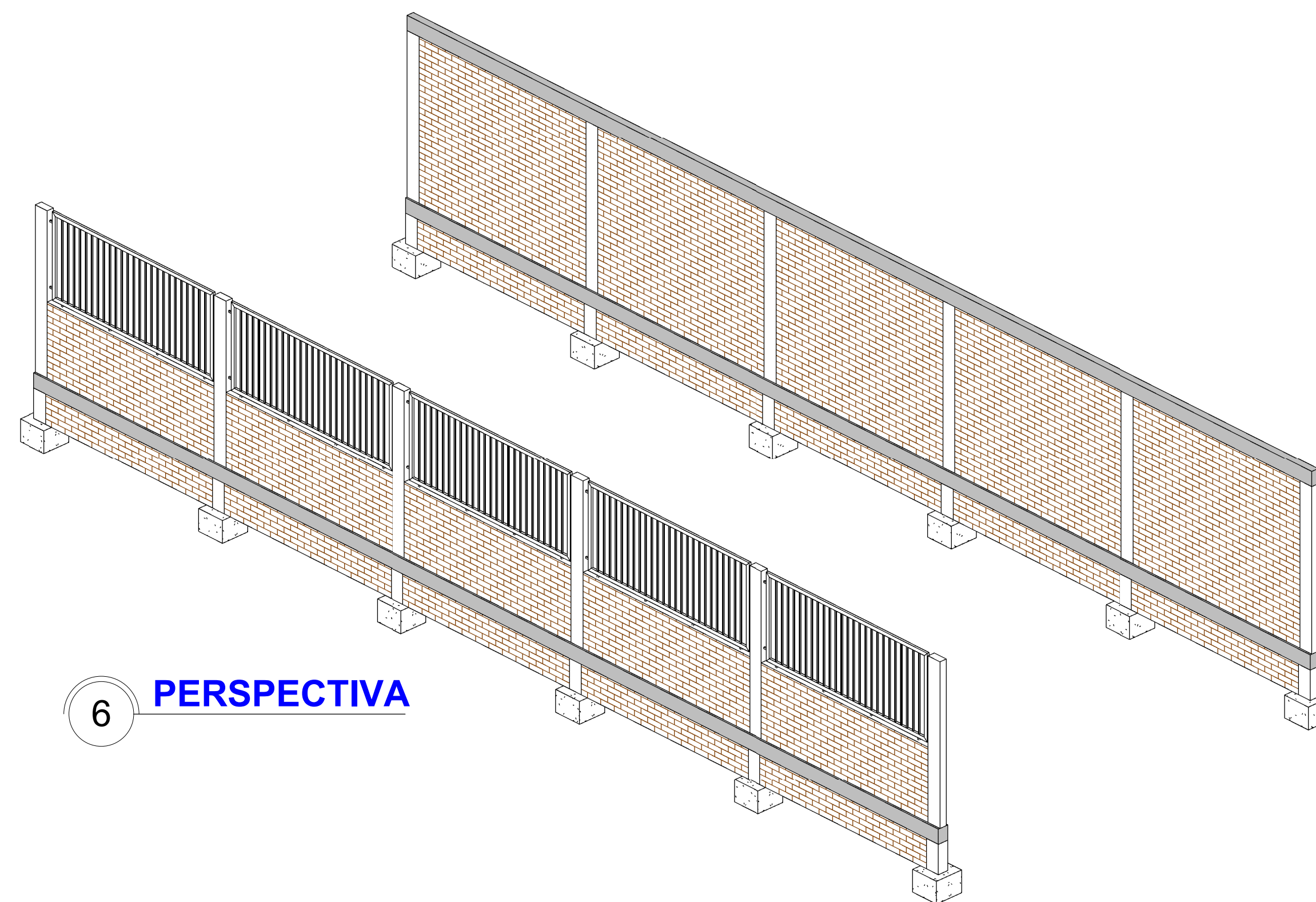

6 PERSPECTIVA

	OBRA	MURO DAS ESCOLAS DA ZONA RURAL	01/01
	PROPRIETÁRIO	Secretaria Municipal de Educação – SEMED	ÁREA TERRENO
	RESP. TÉCNICO	HUGO CARVALHO CARDOSO	ÁREA CONSTRUIDA
	ENDEREÇO	Travessa 28 de Abril, nº 1176 – CEP 68.148-000 – Brasil Novo – PA	2.820,00 M
	PROJETO	ARQUITETÔNICO	INDICADA
			1516632230